



N O R T H E R N
Analytical Services, LLC.
ENVIRONMENTAL CONSULTANTS

**Three Year
Asbestos
Re-Inspection
Report**

For

**New Branches Charter Academy
3662 Poinsettia Avenue, SE
Grand Rapids, Michigan 49508**

Prepared By:

**Northern Analytical Services, LLC.
PO Box 1604
Big Rapids, Michigan 49307**

**Project No.: 240160
Report Date: September 09, 2024**

Table of Contents

Introduction	2
Company Statement	4
Asbestos Background	5
Survey Procedures	5
Unknown Suspect Materials	5
Facility Recommendations	6
Management Planner’s Recommendations	8
School Building Number 1 - New Branches Charter Academy.....	8
Inspection Statement.....	9
Management Plan Statement.....	9
Local Education Information	10
Training Certification	10
LEA Responsibility Certification	11
Annual Notification	12
Appendix A	13
Notifications & Forms.....	13
Annual AHERA Notification	14
Asbestos Removal Notification.....	15
Asbestos Acknowledgement	16
Periodic Surveillance	17
Appendix B	18
Inspection Data.....	18

Introduction

The following Three-Year Asbestos Re-Inspection Report was completed by Northern Analytical Services, LLC. (NAS) for New Branches Charter Academy located at 3662 Poinsettia Avenue, SE, Grand Rapids, Michigan 49508. Re-inspection activities were limited to the known or assumed asbestos containing materials identified in the previous re-inspection report.

In accordance with the US EPA under the National Emissions Standard for Hazardous Air Pollutants (NESHAPs), building owners and their contractors are responsible for having building materials tested for asbestos content prior to disturbance. This re-inspection is not intended to satisfy NESHAP requirements; Additional inspection and testing services will be necessary before performing renovations or other activities that will otherwise disturb building materials.

In accordance with the Asbestos Hazard Emergency Response Act (AHERA), all buildings owned and/or operated by K-12 school districts are required to be incorporated in the district's management plan. These regulations allow for buildings, or portions of buildings, constructed after 1988 to either be inspected for the presence of asbestos containing materials (ACM) or be accompanied by a statement from the architect/construction manager that no ACM was installed during construction activities. It is recommended that acceptable statements be obtained and attached to this report for any future renovation/construction activities.

New Branches Charter Academy
3 Year Re-Inspection Report
Project No.: 240160
Report Date: September 9, 2024

This re-inspection included the following buildings:

School Building Number	Building	Address	Re-Inspection Date
1	New Branches Charter Academy	3662 Poinsettia Avenue, SE, Grand Rapids, Michigan 49508	8/22/2024

New Branches Charter Academy
3 Year Re-Inspection Report
Project No.: 240160
Report Date: September 9, 2024

Company Statement

This Re-inspection Report and Management Plan update was prepared by NAS to assist New Branches Charter Academy in meeting the 3 Year Re-Inspection requirements set forth by AHERA.

In preparation of this document, every attempt has been made to recommend the least burdensome response actions consistent with protecting human health and the environment as specified by AHERA.

AHERA states that the management plan is the responsibility of the owner/operator of the facility, also called the Local Education Agency (LEA); in this case the LEA is New Branches Charter Academy. It is the responsibility of the LEA to read and understand the response actions, their obligations, timetables, and to determine if these actions are reasonable actions prior to signing the owner/operator statement. Any changes or additions to this document without written authorization from NAS will automatically void the inspection and management plan statements.

If the LEA decides to make changes to this report without authorization from NAS or decides to make changes which conflict with the advice and/or professional judgment of NAS, a separate statement shall accompany the management plan and should specify which recommended actions the owner/operator has decided to change, the actual changes and rationale for the changes. NAS will not accept any responsibility for changes to any response actions that weren't stated previously by NAS.

Asbestos Background

Asbestos is a naturally occurring mineral. It is distinguished from other minerals by the fact that its crystals form long, thin fibers. Deposits of asbestos are found throughout the world. The primary sites of commercial production are Canada, China, Brazil, Zimbabwe, and South Africa. Asbestos is also mined commercially in limited quantities in the United States, in California and Vermont.

Asbestos has been used in thousands of products. Collectively, these are referred to as asbestos-containing material (ACM). Asbestos gained wide-spread use because it was plentiful, readily available and low in cost. Because of its unique properties – fire resistance, high tensile strength, poor heat and electrical conductivity and being generally impervious to chemicals attacks – asbestos proved well-suited for many uses in the construction trades.

Asbestos-related diseases are chronic diseases and symptoms usually do not appear for 15 to 40 years after initial exposures to airborne asbestos fibers. In nearly all cases, many years of exposure to high levels of airborne ACM is necessary for personnel to contract asbestos-related diseases.

The primary exposure route is inhalation. Inhaled fibers may become embedded in the bronchial tubes or alveoli, or they may pass through to the pleura – the lining of the chest cavity. Asbestos-related diseases include asbestosis, lung cancer, mesothelioma and gastrointestinal cancers.

Survey Procedures

Survey procedures were conducted by a State of Michigan accredited Asbestos Building Inspector in accordance with AHERA requirements.

To complete this survey, the inspector(s) reviewed the most recent re-inspection report and performed an inspection of the materials identified in that report as either known or assumed to be asbestos containing. During the inspection, the inspector visually inspected materials for damage or the potential for damage.

NAS did not conduct a thorough inspection of the building(s) to determine the presence, location, or quantity of materials suspected to contain asbestos. NAS only inspected the materials identified in the previous re-inspection. Prior to performing any renovation work NAS strongly recommends a thorough building inspection be performed.

Unknown Suspect Materials

It is likely that there are suspect asbestos containing materials present that have not been identified in this re-inspection or in previous AHERA inspections. Keep in mind

that in 1988 when AHERA was enacted many inspectors were new and likely missed some of the suspect materials. Additionally, new building materials have likely been added since the original AHERA inspection. It is a common misconception that asbestos has been banned, it is still legal to sell many types of building materials yet today that contain asbestos.

In addition to unknown/untested materials, many known asbestos containing materials have been removed over the years through renovation or maintenance activities. It is possible that the conditions at the time work was completed would not allow for complete removal and some portion of the ACM remain. The following are examples of this:

- Cabinets and unit vent heaters cover old floor tile.
- Floor tile was removed but the asbestos containing mastic remains and was covered with new flooring.
- Pipe insulation was abated where exposed but the asbestos insulation extends into a wall cavity.
- Spray applied acoustical ceilings were scrapped but the non-asbestos plaster substrate remains along with asbestos containing overspray above it.
- Spray applied fire proofing was removed but residual overspray remains in wall cavities and other hidden areas.

To help ensure suspect ACMs are not unknowingly disturbed it is crucial that the NESHAP regulations are closely followed and every space be thoroughly inspected and every building material be tested prior to disturbance. This report does not cover unknown or hidden suspect materials.

Facility Recommendations

Based on the findings of the Inspector, the following general site recommendations have been made:

Careful review of the included Response Action Report should be conducted by the Districts Designated Person. The reports titled Material Report will provide a detailed description of the suspect ACM found, asbestos content, friability, type of asbestos present, and the total quantity found in each building. Reports titled Response Action Report will provide a description of what ACMs were found in each room, comments on the specific location and damage if any was observed and response actions to be taken for each of the known or assumed ACM.

For materials that have been identified as damaged, it is recommended that a licensed abatement contractor be contacted to make any repairs or to conduct any removal activities needed.

New Branches Charter Academy
3 Year Re-Inspection Report
Project No.: 240160
Report Date: September 9, 2024

In accordance with CFR 1910.1200, it is recommended that each ACM be properly labeled as asbestos containing. Warning labels should contain the following information:

Danger
Contains Asbestos Fibers
Avoid Creating Dust
Cancer and Lung Disease Hazard

Labels should be placed in various locations on each material in a manner to avoid accidental disturbance.

Prior to any renovation or maintenance activity, review the Management Plan to ensure materials being impacted by the renovation/activity do not contain asbestos. Should materials likely to be disturbed not be accurately described in the inspection reports, contact a licensed Asbestos Building Inspector to collect samples. Do not disturb materials not described in the Management Plan or materials identified as asbestos containing or assumed to contain asbestos.

If a disturbance occurs, either accidental or planned (abatement project), area air monitoring should be conducted to establish the airborne concentration of asbestos fibers present. Both State and Federal Agency strictly govern disturbance activities and exposure to employees and building occupants. Proper air sampling can determine if area contamination has occurred as well as help assure employees and building occupants in adjacent areas are not being exposed. In addition to area monitoring, AHERA requires third party area air clearance testing whenever a disturbance occurs.

Records of future renovation activities should be kept. These records should include what materials were disturbed and to what extent. Also, information on replacement materials is vital in keeping this survey up to date. Often Architects or Design Engineers can provide legal statements indicating that replacement materials do not contain asbestos. Other documentation of this sort would be material or product safety data sheets. If proper documentation is not available for suspect ACM's located in building constructed prior to 1986, sample collection and analysis is required by State and Federal Regulations.

Both CFR 1910.110 and CFR 1926.110 require that employers provide awareness training to all employees that are expected to come in contact with or required to work in the general vicinity of ACM. In accordance with regulatory requirements, it is recommended that all housekeeping and maintenance employees receive, at a minimum, 2-hour asbestos awareness training. In addition, employees that are required to conduct minor cleanup projects shall be provided additional training.

Management Planner's Recommendations

All of the ACM or suspect ACM identified in this report was noted by the inspector as being in good condition unless specifically mentioned below under each building name. Continue the facility's operations and maintenance program and conduct periodic assessments (at least every 6 months) of all known or assumed asbestos containing materials.

The following recommendations (not all inclusive, see Response Actions for additional recommendations) are based on the inspector's findings, laboratory results and the management planner's opinion. Please note that all work described below must be completed either by in house properly trained 16-hour asbestos operations and maintenance personnel or a licensed asbestos abatement contractor. Third-party air clearance testing should be conducted following any repair/removal actions described below:

School Building Number 1 - New Branches Charter Academy

1. All known friable ACM observed during this re-inspection was found to be in good condition, continue to maintain materials in accordance with the Operations and Maintenance Program.

Signature Page

Inspection Statement

The person(s) listed below hereby attest(s) that he/she/they did inspect, assess and perform sampling of suspect asbestos containing building materials (ACBM) at the buildings/portions of buildings listed in this report in accordance with AHERA regulations set forth in 40 CFR Section 763.85(a):

Name	Accreditation Number	Signature	Date
Joshua Christie	A60272		9/9/2024



Management Plan Statement

The person(s) listed below hereby attest(s) that he/she/they did review the asbestos re-inspection data collected by the asbestos building inspector for this re-inspection. Any recommendations are based on the above referenced inspection in accordance with AHERA regulations set forth in 40 CFR Section 763.93 (12), (ii).

Name	Accreditation Number	Signature	Date
John Rehkopf	A16809		9/9/2024

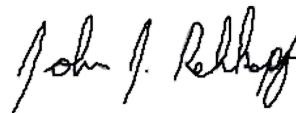

New Branches Charter Academy
3 Year Re-Inspection Report
Project No.: 240160
Report Date: September 9, 2024

Local Education Information

Local Education Agency (LEA): New Branches Charter Academy
LEA Address: 3662 Poinsettia Avenue, SE, Grand Rapids, Michigan 49508
Designated Person: Terry Larkin
Designated Person Address: 3662 Poinsettia Avenue, SE, Grand Rapids, Michigan 49508
Designated Person Telephone: 616-243-6221

Training Certification

The Designated Person(s) listed above attests that he/she/they received adequate training covering the Local Education Agency’s (LEA) responsibilities for Designated Person in accordance with 763.93 (e)(4). This training included:

- The health effects of asbestos exposure
- Detection, identification and assessment of ACBM
- Options for controlling ACBM
- Asbestos management programs
- Relevant State and Federal regulations regarding asbestos
- The LEA/Designated Person responsibilities.

Training was provided by: _____

Under the course titled: Asbestos Designated Person Training

on: _____ and was _____ hours in length.

Designated Person Signature: _____ Date _____
Terry Larkin

LEA Responsibility Certification

The Designated Person listed above certifies that the general LEA responsibilities as required by 763.84 have been or will be satisfied. This includes the following actions:

1. Anyone who conducts any inspections, re-inspections or abatement projects; develops or updates management plans; or performs operations and maintenance that will disturb ACM are licensed asbestos professionals.
2. All custodial and maintenance staff have received two-hour asbestos awareness training and 14 hours of operations and maintenance training (along with annual refreshers) as described in AHERA.
3. The parents, teachers and employee organizations are notified on an annual basis of all inspections, response actions and periodic surveillance that are planned or in progress in regard to asbestos in each school building.
4. Short-term workers (e.g., telephone repair workers, utility workers or exterminators) are informed of the locations of ACBM in school buildings.
5. Warning signs are posted immediately adjacent to ACM in routine maintenance areas that state:

Danger. Asbestos. Hazardous.
Do Not Disturb
Without Proper Training and Equipment

6. Parents, teachers and employee organizations are notified in writing on an annual basis of the availability of the school’s asbestos management plan.
7. The management plans are available for inspection in each school and the district office.
8. Records are properly maintained.
9. Each management plan contains a statement, signed by the designated person that certifies the LEA’s responsibilities have been or will be met. The statement needs to be amended for each new designated person chosen by the LEA.
10. Re-inspections are conducted at least once every three years after a management plan is in effect.

As the Designated Person for New Branches Charter Academy, I will ensure that the above items are completed in accordance with AHERA.

Signature of Designated Person

Terry Larkin

Date

Annual Notification

Annual AHERA Notifications to Employees, Students, and Parents.

The Asbestos Hazard Emergency Response Act (AHERA) requires schools to "ensure that workers and building occupants, or their legal guardians, are informed at least once each school year about inspections, response actions, and post-response action activities, including periodic reinspection and surveillance activities that are planned or in progress (763.84(c)). Such notification must be done in writing and a copy placed in the management plan. Suggested notification methods may be through the publication of an article in a school district newsletter or through a separate written notice distributed to staff and sent home to a student's parent or legal guardian.

In addition, schools "shall make management plans available for inspection to representatives of EPA and the State, the public, including parents, teachers, and other school personnel within 5 working days after receiving a request for inspection (763.93(g)(3)). Furthermore, "the local education agency shall notify in writing parent, teacher, and employee organizations of the availability of management plans and shall include in the management plan a description of steps to notify such organizations, and a dated copy of the notification. In the absence of any such organizations for parents, teachers, or employees, the local education agency shall provide written notice to that relevant group of the availability of management plans and shall include in the management plan a description of the steps taken to notify such groups and a dated copy of the notification" (763.93(g)(4).

The LEA asbestos designated person for the school district is to ensure that these AHERA required notifications occur each school year. The school may determine when to do AHERA notification, as long as it occurs at least once each school year.

A copy of the annual notification can be found in Appendix A.

Appendix A
Notifications & Forms

Annual AHERA Notification

New Branches Charter Academy has an Asbestos Management Plan in place in accordance with the Asbestos Hazard Emergency Response Act (AHERA). The plan is available for review in the main office. Please call Ms. Terry Larkin at (616-243-6221) to view during normal operational hours, 8AM to 4PM Monday through Friday with the exception of holidays.

In accordance with AHERA requirements, New Branches Charter Academy has contracted Northern Analytical Services, LLC. (NAS) to perform all re-inspections of known asbestos containing materials present, to prepare written project designs for all response actions and to perform all post response action testing. As part of this plan, NAS performed the most recent 3-year re-inspection on 8/22/2024.

Over the past 12 months, the following materials were removed from our buildings:

240 square feet of floor tile and mastic

2 mudded pipe fittings

3 fire rated doors

In the next 12 months we are planning to remove the following materials from our buildings:

Prior to conducting any work that disturbs asbestos, New Branches Charter Academy will notify all parents and building staff in advance.

Sincerely,

Terry Larkin
New Branches Charter Academy

Asbestos Removal Notification

In an effort to provide our students with the best learning environment possible, New Branches Charter Academy is planning a building improvement project that will require the disturbance of asbestos containing materials. We have retained the services of a State of Michigan accredited Asbestos Project Designer to prepare written specifications to help ensure the work is completed in the safest manner possible. All removal work will be performed by a State of Michigan licensed asbestos abatement contractor and overseen by a qualified third-party air quality testing firm.

Third party air clearance testing will be performed before the areas affected by the asbestos removal are returned to normal use.

Asbestos Removal is scheduled to be removed from the following buildings:

Building Name	Start Date	Completion Date

Please contact our District's Designated Person, Ms. Terry Larkin at 616-243-6221 with any questions.

Local Education Agency (LEA) Name

New Branches Charter Academy

School Building Number/Name

1-New Branches Charter Academy

Periodic Surveillance

1. Name of Person Performing the Surveillance:

Last

First

M.I.

--	--	--

2. Date of the Surveillance:

--

3. Description of any Changes in the Condition of the Materials:

--

Appendix B

Inspection Data

New Branches Charter Academy

Material Report

Northern Analytical Services

14870 225th Avenue, Big Rapids, MI 49307 - (231) 268-0004 - Fax (866) 214-4739

Customer:
Building:
Address:

Choice Schools Associates
New Branches Charter Academy
3662 Poinsettia Avenue SE
Grand Rapids, MI 49508

Printed:

September 9, 2024

Material Report

<i>Material Number</i>	<i>Homogeneous Material Description</i>	<i>Category</i>	<i>Friability*</i>	<i>RACM**</i>	<i>Asbestos Detected</i>	<i>Percent Asbestos</i>	<i>Asbestos Type</i>	<i>Quantity</i>	<i>Units</i>
1	Boiler Insulation - Jacket	Thermal	Yes	Yes	Yes	---	Assumed	295	Sq.Ft.
2	Pipe Insulation - Wrap	Thermal	Yes	Yes	Yes	---	Assumed	110	Ln.Ft.
3	Pipe Insulation-Mudded Fitting -	Thermal	Yes	Yes	Yes	---	Assumed	292	Ln.Ft.
4	Floor Tile & Mastic -	Misc.	Category I Non-Friable	No	Yes	---	Assumed	23845	Sq.Ft.
5	Gasket -	Misc.	Category I Non-Friable	No	Yes	---	Assumed	15	Ln.Ft.
8	Fire Rated Door -	Misc.	Category II Non-Friable	No	Yes	---	Assumed	11	Each
9	Glue - Pods From Old Ceiling Tiles	Misc.	Category II Non-Friable	No	Yes	5%	Chrysotile	9400	Sq.Ft.
10	Floor Tile & Mastic - 9x9 Green	Misc.	Category I Non-Friable	No	Yes	T-5% M-A	Chrysotile	0	Sq.Ft.
11	Debris - Pipe Chase in Custodian 2	Thermal	Yes	No	No	---	None Detected	Not Quantified	Sq.Ft.

* Non-Friable materials may become friable when damaged.

** May become regulated asbestos containing material (RACM) when damaged.

Misc. = miscellaneous material

Surfacing = surfacing material

Thermal = thermal system insulation

RACM = regulated asbestos containing material

Response Action Report

Northern Analytical Services

14870 225th Avenue, Big Rapids, MI 49307 - (231) 268-0004 - Fax (866) 214-4739

LEA:
Building:
Building No.:
Address:

Choice Schools Associates
New Branches Charter Academy
1
3662 Poinsettia Avenue SE
Grand Rapids, MI 49508

Response Action Report

Printed:

September 9, 2024

<i>Room Number</i>	<i>Material Number</i>	<i>Homogeneous Material Description</i>	<i>Quantity</i>	<i>Units</i>	<i>Comments</i>	<i>Response Action (AHERA Ranking)</i>
001	4	Floor Tile & Mastic -	800	Sq.Ft.	Under Carpet	maintain with O&M plan. (7)
001	8	Fire Rated Door -	0	Each	Removed	(0)
002	4	Floor Tile & Mastic -	800	Sq.Ft.	Assumed Under Vinyl Sheet Flooring	maintain with O&M plan. (7)
002	8	Fire Rated Door -	1	Each		maintain with O&M plan. (7)
003	4	Floor Tile & Mastic -	800	Sq.Ft.	Assumed Under Carpet	maintain with O&M plan. (7)
003	8	Fire Rated Door -	1	Each		maintain with O&M plan. (7)
004	4	Floor Tile & Mastic -	800	Sq.Ft.	Assumed Under Carpet	maintain with O&M plan. (7)
004	8	Fire Rated Door -	0	Each	Removed	(0)
005	4	Floor Tile & Mastic -	800	Sq.Ft.	Assumed Under Vinyl Sheet Flooring	maintain with O&M plan. (7)
005	8	Fire Rated Door -	1	Each		maintain with O&M plan. (7)
010	4	Floor Tile & Mastic -	800	Sq.Ft.	Assumed Under Carpet	maintain with O&M plan. (7)
011	4	Floor Tile & Mastic -	1100	Sq.Ft.	Assumed Under Carpet	maintain with O&M plan. (7)
011	9	Glue - Pods From Old Ceiling Tiles	1100	Sq.Ft.	Above Ceiling Tiles	maintain with O&M plan. (7)
012	4	Floor Tile & Mastic -	800	Sq.Ft.	Assumed Under Carpet	maintain with O&M plan. (7)
012	9	Glue - Pods From Old Ceiling Tiles	800	Sq.Ft.	Above Ceiling Tiles	maintain with O&M plan. (7)
013	4	Floor Tile & Mastic -	1100	Sq.Ft.	Assumed Under Carpet	maintain with O&M plan. (7)

Northern Analytical Services

14870 225th Avenue, Big Rapids, MI 49307 - (231) 268-0004 - Fax (866) 214-4739

LEA:
Building:
Building No.:
Address:

Choice Schools Associates
New Branches Charter Academy
1
3662 Poinsettia Avenue SE
Grand Rapids, MI 49508

Response Action Report

Printed:

September 9, 2024

<i>Room Number</i>	<i>Material Number</i>	<i>Homogeneous Material Description</i>	<i>Quantity</i>	<i>Units</i>	<i>Comments</i>	<i>Response Action (AHERA Ranking)</i>
013	9	Glue - Pods From Old Ceiling Tiles	1100	Sq.Ft.	Above Ceiling Tiles	maintain with O&M plan. (7)
014	4	Floor Tile & Mastic -	800	Sq.Ft.	Assumed Under Carpet	maintain with O&M plan. (7)
014	9	Glue - Pods From Old Ceiling Tiles	800	Sq.Ft.	Above Ceiling Tiles	maintain with O&M plan. (7)
015	4	Floor Tile & Mastic -	280	Sq.Ft.	Assumed Under Carpet	maintain with O&M plan. (7)
015.1	4	Floor Tile & Mastic -	80	Sq.Ft.	Assumed Under Carpet	maintain with O&M plan. (7)
016	4	Floor Tile & Mastic -	800	Sq.Ft.	Assumed Under Carpet	maintain with O&M plan. (7)
016	9	Glue - Pods From Old Ceiling Tiles	800	Sq.Ft.	Above Ceiling Tiles	maintain with O&M plan. (7)
017	4	Floor Tile & Mastic -	800	Sq.Ft.	Assumed Under Carpet	maintain with O&M plan. (7)
017	9	Glue - Pods From Old Ceiling Tiles	800	Sq.Ft.	Above Ceiling Tiles	maintain with O&M plan. (7)
018	4	Floor Tile & Mastic -	800	Sq.Ft.	Assumed Under Carpet	maintain with O&M plan. (7)
018	9	Glue - Pods From Old Ceiling Tiles	800	Sq.Ft.	Above Ceiling Tiles	maintain with O&M plan. (7)
019	4	Floor Tile & Mastic -	800	Sq.Ft.	Assumed Under Carpet	maintain with O&M plan. (7)
020	4	Floor Tile & Mastic -	800	Sq.Ft.	Assumed Under Carpet	maintain with O&M plan. (7)
020	9	Glue - Pods From Old Ceiling Tiles	800	Sq.Ft.	Above Ceiling Tiles	maintain with O&M plan. (7)
021	4	Floor Tile & Mastic -	800	Sq.Ft.	Assumed Under Carpet	maintain with O&M plan. (7)
021	9	Glue - Pods From Old Ceiling Tiles	800	Sq.Ft.	Above Ceiling Tiles	maintain with O&M plan. (7)

Northern Analytical Services

14870 225th Avenue, Big Rapids, MI 49307 - (231) 268-0004 - Fax (866) 214-4739

LEA:
Building:
Building No.:
Address:

Choice Schools Associates
New Branches Charter Academy
1
3662 Poinsettia Avenue SE
Grand Rapids, MI 49508

Response Action Report

Printed:

September 9, 2024

<i>Room Number</i>	<i>Material Number</i>	<i>Homogeneous Material Description</i>	<i>Quantity</i>	<i>Units</i>	<i>Comments</i>	<i>Response Action (AHERA Ranking)</i>
022	4	Floor Tile & Mastic -	800	Sq.Ft.	12x12in, Half Assumed Under Carpet	maintain with O&M plan. (7)
022	9	Glue - Pods From Old Ceiling Tiles	800	Sq.Ft.	Above Ceiling Tiles	maintain with O&M plan. (7)
023	4	Floor Tile & Mastic -	800	Sq.Ft.	12x12in, Half Assumed Under Carpet	maintain with O&M plan. (7)
023	9	Glue - Pods From Old Ceiling Tiles	800	Sq.Ft.	Above Ceiling Tiles	maintain with O&M plan. (7)
Boiler Room	1	Boiler Insulation - Jacket	295	Sq.Ft.		maintain with O&M plan. (7)
Boiler Room	3	Pipe Insulation-Mudded Fitting -	6	Ln.Ft.		maintain with O&M plan. (7)
Boiler Room	5	Gasket -	15	Ln.Ft.	On Boiler	maintain with O&M plan. (7)
Boiler Room	8	Fire Rated Door -	0	Each	Removed	(0)
Boiler Room 2	8	Fire Rated Door -	2	Each		maintain with O&M plan. (7)
Boys 2	3	Pipe Insulation-Mudded Fitting -	8	Ln.Ft.		maintain with O&M plan. (7)
Custodian 1	8	Fire Rated Door -	0	Each	Removed	(0)
Custodian 2	3	Pipe Insulation-Mudded Fitting -	26	Ln.Ft.		maintain with O&M plan. (7)
Custodian 2	8	Fire Rated Door -	1	Each		maintain with O&M plan. (7)
Girls 2	3	Pipe Insulation-Mudded Fitting -	4	Ln.Ft.		maintain with O&M plan. (7)
Gym Storage 1	4	Floor Tile & Mastic -	200	Sq.Ft.	9x9	maintain with O&M plan. (7)
Gym Storage 2	3	Pipe Insulation-Mudded Fitting -	0	Ln.Ft.	Abated October 2023	(4)

Northern Analytical Services

14870 225th Avenue, Big Rapids, MI 49307 - (231) 268-0004 - Fax (866) 214-4739

LEA:
Building:
Building No.:
Address:

Choice Schools Associates
New Branches Charter Academy
1
3662 Poinsettia Avenue SE
Grand Rapids, MI 49508

Response Action Report

Printed:

September 9, 2024

<i>Room Number</i>	<i>Material Number</i>	<i>Homogeneous Material Description</i>	<i>Quantity</i>	<i>Units</i>	<i>Comments</i>	<i>Response Action (AHERA Ranking)</i>
Gym Storage 2	4	Floor Tile & Mastic -	0	Sq.Ft.	Abated October 2023	(0)
Hall 1	4	Floor Tile & Mastic -	750	Sq.Ft.	12x12	maintain with O&M plan. (7)
Hall 2	4	Floor Tile & Mastic -	400	Sq.Ft.	12x12	maintain with O&M plan. (7)
Hall 3	4	Floor Tile & Mastic -	1600	Sq.Ft.	12x12	maintain with O&M plan. (7)
Hall 4	4	Floor Tile & Mastic -	600	Sq.Ft.	12x12, Under Carpet	maintain with O&M plan. (7)
Hall 4	4	Floor Tile & Mastic -	1900	Sq.Ft.	9x9, Under Carpet	maintain with O&M plan. (7)
Hall 5	4	Floor Tile & Mastic -	1100	Sq.Ft.	12x12	maintain with O&M plan. (7)
Janitor 1	4	Floor Tile & Mastic -	30	Sq.Ft.	9x9	maintain with O&M plan. (7)
Janitor 1	8	Fire Rated Door -	1	Each		maintain with O&M plan. (7)
Kitchen	3	Pipe Insulation-Mudded Fitting -	0	Ln.Ft.	Could Not Find	maintain with O&M plan. (7)
Kitchen	4	Floor Tile & Mastic -	0	Sq.Ft.	Removed	(0)
Locker Room	3	Pipe Insulation-Mudded Fitting -	20	Ln.Ft.		maintain with O&M plan. (7)
Locker Room	4	Floor Tile & Mastic -	0	Sq.Ft.	Removed	(0)
Office	4	Floor Tile & Mastic -	475	Sq.Ft.	Assumed Under Carpet	maintain with O&M plan. (7)
Principals Office	4	Floor Tile & Mastic -	350	Sq.Ft.	Assumed Under Carpet	maintain with O&M plan. (7)
Principals Office	8	Fire Rated Door -	1	Each		maintain with O&M plan. (7)

Northern Analytical Services

14870 225th Avenue, Big Rapids, MI 49307 - (231) 268-0004 - Fax (866) 214-4739

LEA:
Building:
Building No.:
Address:

Choice Schools Associates
New Branches Charter Academy
1
3662 Poinsettia Avenue SE
Grand Rapids, MI 49508

Response Action Report

Printed:

September 9, 2024

<i>Room Number</i>	<i>Material Number</i>	<i>Homogeneous Material Description</i>	<i>Quantity</i>	<i>Units</i>	<i>Comments</i>	<i>Response Action (AHERA Ranking)</i>
Printer	4	Floor Tile & Mastic -	120	Sq.Ft.	Assumed Under Carpet	maintain with O&M plan. (7)
Stage	4	Floor Tile & Mastic -	650	Sq.Ft.	12x12	maintain with O&M plan. (7)
Stage	4	Floor Tile & Mastic -	70	Sq.Ft.	9x9	maintain with O&M plan. (7)
Storage 1	4	Floor Tile & Mastic -	130	Sq.Ft.	9x9	maintain with O&M plan. (7)
Storage 1	8	Fire Rated Door -	2	Each		maintain with O&M plan. (7)
Storage 2	3	Pipe Insulation-Mudded Fitting -	10	Ln.Ft.		maintain with O&M plan. (7)
Storage 2	3	Pipe Insulation-Mudded Fitting -	1	Ln.Ft.	Roof Drain	maintain with O&M plan. (7)
Storage 2	8	Fire Rated Door -	1	Each		maintain with O&M plan. (7)
Teachers R.R.	4	Floor Tile & Mastic -	0	Sq.Ft.	Removed	()
Tech	4	Floor Tile & Mastic -	110	Sq.Ft.	9x9	maintain with O&M plan. (7)
Tunnel	2	Pipe Insulation - Wrap	110	Ln.Ft.		maintain with O&M plan. (7)
Tunnel	3	Pipe Insulation-Mudded Fitting -	217	Ln.Ft.		maintain with O&M plan. (7)

Sample Location Report

Northern Analytical Services

14870 225th Avenue, Big Rapids, MI 49307 - (231) 268-0004 - Fax (866) 214-4739

Customer:

Building:

Address:

Choice Schools Associates
New Branches Charter Academy
3662 Poinsettia Avenue SE
Grand Rapids, MI 49508

Printed:

September 9, 2024

Sample Location Report

<i>Sample Number</i>	<i>Material Number</i>	<i>Homogeneous Material Description</i>	<i>Room Number</i>	<i>Sample Location</i>
1001	10	Floor Tile & Mastic - 9x9 Green	Gym Storage 2	NE Corner
1002	10	Floor Tile & Mastic - 9x9 Green	Gym Storage 2	NW Corner
1101	11	Debris - Pipe Chase in Custodian 2	Custodian 2	Inside Pipe Chase
1102	11	Debris - Pipe Chase in Custodian 2	Custodian 2	Inside Pipe Chase

Laboratory Report



The Identification Specialists

Analysis Report
prepared for
Northern Analytical Services, LLC

Report Date: 8/23/2024

Project Name: New Branchs

Project #: 240160

SanAir ID#: 24047799



NVLAP LAB CODE 600227-0

11709 Chesterdale Road | Cincinnati, Ohio 45246
888.895.1177 | 513.438.6006 | IAQ@SanAir.com | SanAir.com



SanAir ID Number

24047799

FINAL REPORT

8/23/2024 10:56:02 AM

Name: Northern Analytical Services, LLC
Address: 14870 225th Avenue
Big Rapids, MI 49307
Phone: 231-679-0005

Project Number: 240160
P.O. Number:
Project Name: New Branches
Collected Date: 8/22/2024
Received Date: 8/23/2024 10:15:00 AM

Dear Josh Christie,

We at SanAir would like to thank you for the work you recently submitted. The 2 sample(s) were received on Friday, August 23, 2024 via UPS. The final report(s) is enclosed for the following sample(s): 301, 302.

These results only pertain to this job and should not be used in the interpretation of any other job. This report is only complete in its entirety. Refer to the listing below of the pages included in a complete final report.

Sincerely,

A handwritten signature in black ink that reads "Maureen Y. Haley". The signature is written in a cursive style.

Maureen Y. Haley
Asbestos Laboratory Manager
SanAir Technologies Laboratory

Final Report Includes:

- Cover Letter
- Analysis Pages
- Disclaimers and Additional Information

Sample conditions:

- 2 samples in Good condition.



SanAir ID Number
24047799
 FINAL REPORT
 8/23/2024 10:56:02 AM

Name: Northern Analytical Services, LLC
Address: 14870 225th Avenue
 Big Rapids, MI 49307
Phone: 231-679-0005

Project Number: 240160
P.O. Number:
Project Name: New Branches
Collected Date: 8/22/2024
Received Date: 8/23/2024 10:15:00 AM

Analyst: Farnsworth-Pinkerton, Shoshauna

Asbestos Bulk PLM EPA 600/R-93/116

SanAir ID / Description	Stereoscopic	Components		Asbestos Fibers
	Appearance	% Fibrous	% Non-fibrous	
301 / 24047799-001 Debris	Grey Non-Fibrous Homogeneous	5% Glass 5% Min. Wool	90% Other	None Detected
302 / 24047799-002 Debris	Grey Non-Fibrous Homogeneous	5% Glass 5% Min. Wool	90% Other	None Detected

Analyst:

Approved Signatory:

Analysis Date: 8/23/2024

Date: 8/23/2024

Disclaimer and Additional Information

This report is the sole property of the client named on the SanAir Technologies Laboratory, Inc. (SanAir) chain-of-custody (COC). Results in the report are confidential information intended only for the use by the client named on the COC. Neither results nor reports will be discussed with or released to any third party without our client's written permission to maintain client confidentiality. The final report cannot be reproduced, except in full, without written authorization from SanAir to assure that parts of the report are not taken out of context. This report and any information contained within shall not be edited, altered, or modified in any way by any persons or agencies receiving, viewing, distributing, or otherwise possessing a copy of this final report. The laboratory reserves the right to perform amendments to any finalized report, of which shall supersede and make obsolete any previous editions. Such changes, modifications, additions, or deletions shall be effective immediately upon notice thereof, which may be given by means including, but not limited to, posting on the SanAir client portal website, electronic or conventional mail, or by any other means. The information provided in this report applies only to the samples submitted in the condition they were received at the laboratory and is relevant only for the date, time, and location of sampling. Samples were received in good condition unless otherwise noted on the report. The accuracy of the results is dependent upon the client's sampling procedure and information provided to the laboratory by the client on the COC, which includes the project name, project number, P.O. number, sample collection dates, special instructions, samples collected by, sample numbers, sample identifications/location, sample type, selected analysis type, and total area or volume that may affect the validity of the results. SanAir assumes no responsibility for the sampling procedure and will provide evaluation reports based solely on the sample and information provided by the client. SanAir assumes no responsibility or liability for the manner in which results are used or interpreted. This report does not constitute and shall not be used to claim product, process, system, or person certification, approval, or endorsement by NVLAP, NIST, NELAC, AIHA LAP, LLC or any other agency of the U.S. government; all or some tests contained in this report may not be accredited by every local, state, and federal regulatory agency. Refer to the SanAir website at www.sanair.com for copies of current certificates and scopes of various accreditations, certifications, and licenses or contact the laboratory at iaq@sanair.com for inquiries regarding the status or scope of an accreditation or certification.

Fibers smaller than 5-microns cannot be seen with this method due to scope limitations. Polarized- light microscopy is not consistently reliable in detecting asbestos in floor covering and similar non-friable organically bound materials. Quantitative transmission electron microscopy is currently the only method that can be used to determine if this material can be considered or treated as non-asbestos containing. Samples are held for a period of 60 days.

Asbestos Accreditations, Certifications, and Licenses

National Voluntary Laboratory Accreditation Program (NVLAP) Lab Code 600227-0

State of Connecticut Department of Public Health Registration Number: PH-0817

State of Rhode Island Department of Health, Certification Number: PLM00144, TEM00144

State of West Virginia Bureau for Public Health, Analytical Laboratory Number: LT000637

Texas Department of State Health Services License Number: 300510



10501 Trade Ct., Suite 100
 N. Chesterfield, VA 23236
 804.897.1177 / 888.895.1177
 Fax 804.897.0070
 sanair.com

Asbestos Chain of Custody
 Form 140, Rev 6, 1/26/2022

SanAir ID Number
 24047799

Company: Northern Analytical Services, LLC	Project #: 240160	Collected by: Joshua Christie
Address: 14870 225th Ave.	Project Name: New Branches	Phone #: (231) 679-0005
City, St., Zip: Big Rapids, MI, 49307	Date Collected: 8/22/2024	Fax #: 866-214-4739
State of Collection: MI Account#: 2409	P.O. Number:	Email: kevin@sanair.com

Bulk

ABB	PLM EPA 600/R-93/116	<input checked="" type="checkbox"/>
	Positive Stop	<input checked="" type="checkbox"/>
ABEPA	PLM EPA 400 Point Count	<input type="checkbox"/>
ABB1K	PLM EPA 1000 Point Count	<input type="checkbox"/>
ABBEEN	PLM EPA NOB**	<input type="checkbox"/>
ABBCH	TEM Chatfield**	<input type="checkbox"/>
ABBTM	TEM EPA NOB**	<input type="checkbox"/>
ABQ	PLM Qualitative	<input type="checkbox"/>

Air

ABA	PCM NIOSH 7400	<input type="checkbox"/>
ABA-2	OSHA w/ TWA*	<input type="checkbox"/>
ABTEM	TEM AHERA	<input type="checkbox"/>
ABATN	TEM NIOSH 7402	<input type="checkbox"/>
ABT2	TEM Level II	<input type="checkbox"/>
Other:		<input type="checkbox"/>

Soil

ABSE	PLM EPA 600/R-93/116 (Qual.)	<input type="checkbox"/>
------	------------------------------	--------------------------

Soil

ABSP	PLM CARB 435 (LOD <1%)	<input type="checkbox"/>
ABSP1	PLM CARB 435 (LOD 0.25%)	<input type="checkbox"/>
ABSP2	PLM CARB 435 (LOD 0.1%)	<input type="checkbox"/>

New York ELAP

ABEPA2	NY ELAP 198.1	<input type="checkbox"/>
ABENY	NY ELAP 198.6 PLM NOB	<input type="checkbox"/>
ABBNY	NY ELAP 198.4 TEM NOB	<input type="checkbox"/>

Dust

ABWA	TEM Wipe ASTM D-6480	<input type="checkbox"/>
ABDMV	TEM Microvac ASTM D-5755	<input type="checkbox"/>

Water

ABHE	EPA 100.2	<input type="checkbox"/>
------	-----------	--------------------------

Matrix Other

		<input type="checkbox"/>
--	--	--------------------------

Turn Around Times	3 HR (4 HR TEM) <input checked="" type="checkbox"/>	6 HR (8HR TEM) <input type="checkbox"/>	12 HR <input type="checkbox"/>	1 Day <input type="checkbox"/>
	<input type="checkbox"/> 2 Days	<input type="checkbox"/> 3 Days	<input type="checkbox"/> 4 Days	<input type="checkbox"/> 5 Days

Special Instructions Point Count If < 1%

Sample #	Sample Identification/Location	Volume or Area	Sample Date	Flow Rate*	Start - Stop Time*
301	Debris				
302	Debris				

Relinquished by	Date	Time	Received by	Date	Time
Joshua Christie	8/22/24		RMP	AUG 23 2024	10:15am

If no technician is provided, then the primary contact for your account will be selected. Unless scheduled, the turnaround time for all samples received after 3 pm EST will be logged in the next business day. Weekend or holiday work must be scheduled ahead of time and is charged at 150% of the 3hr TAT or a minimum charge of \$150. A courier charge will be applied for same day and one-day turnaround times for offsite work. SanAir covers Ground and Next Day Air shipping. Shipments billed to SanAir with a faster shipping rate will result in additional charges.

Floor Plan

NEW MAP

New Branch Charter Academy

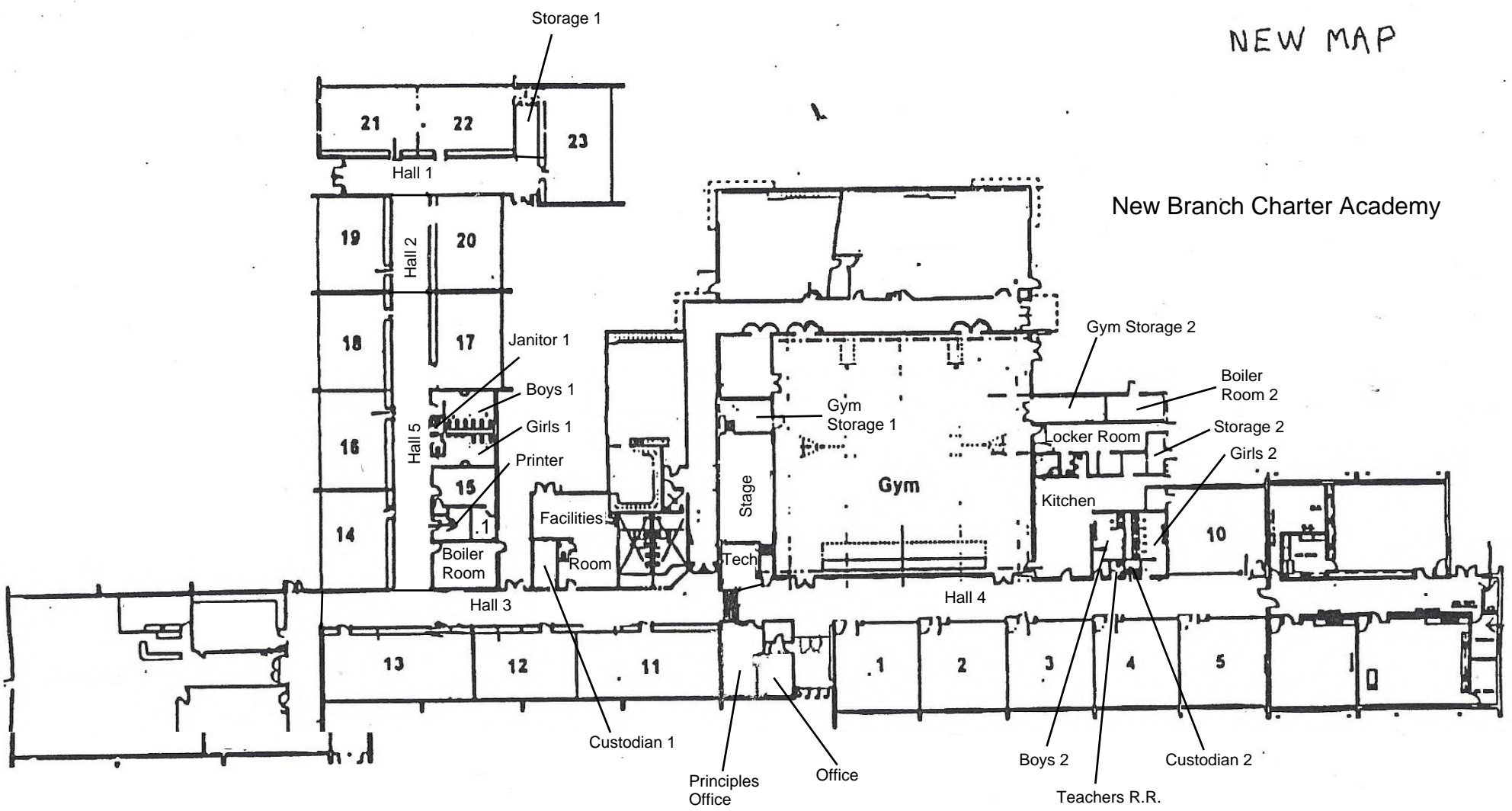

NEW MAP

New Branch Charter Academy

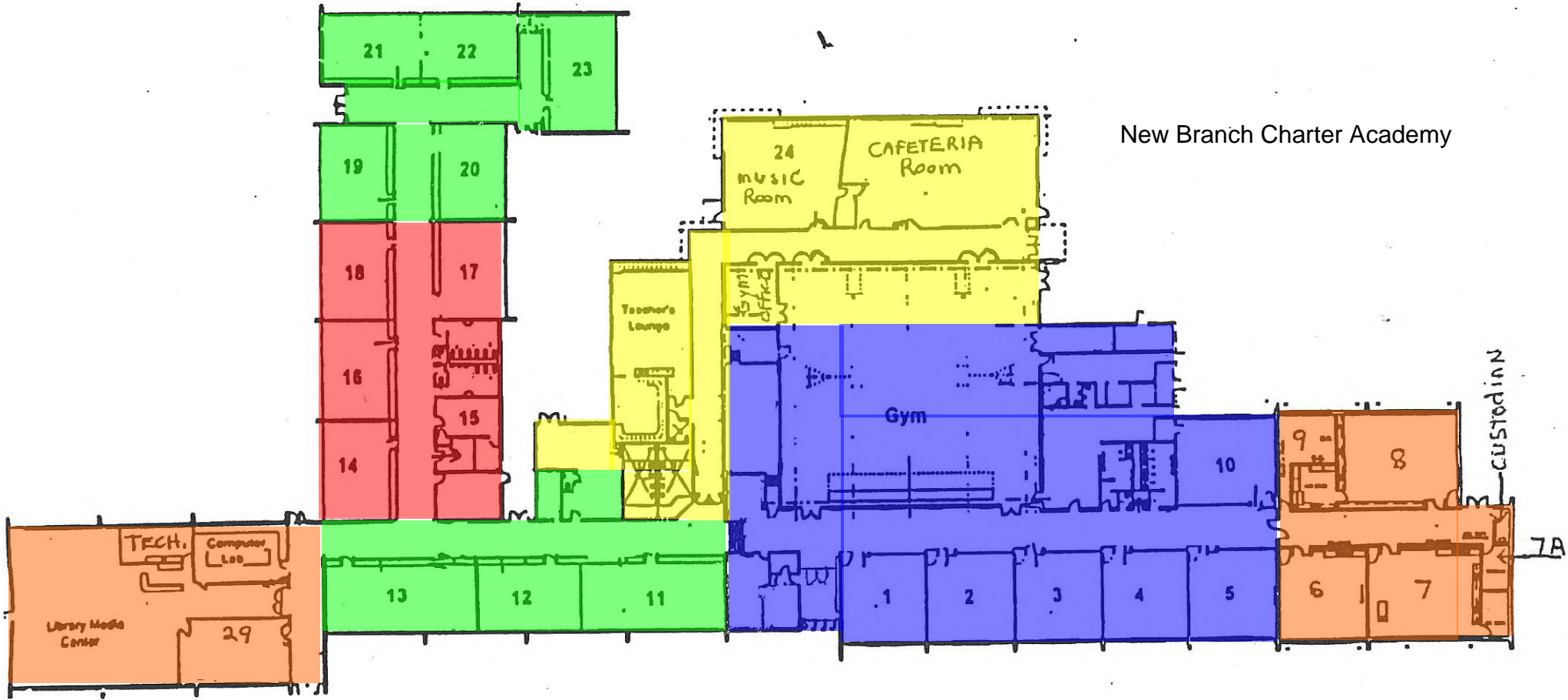

- = 1954 Original Construction
- = 1959 Addition
- = 1965 Addition
- = 1994 Addition
- = 2004 Addition

NEW MAP

New Branch Charter Academy

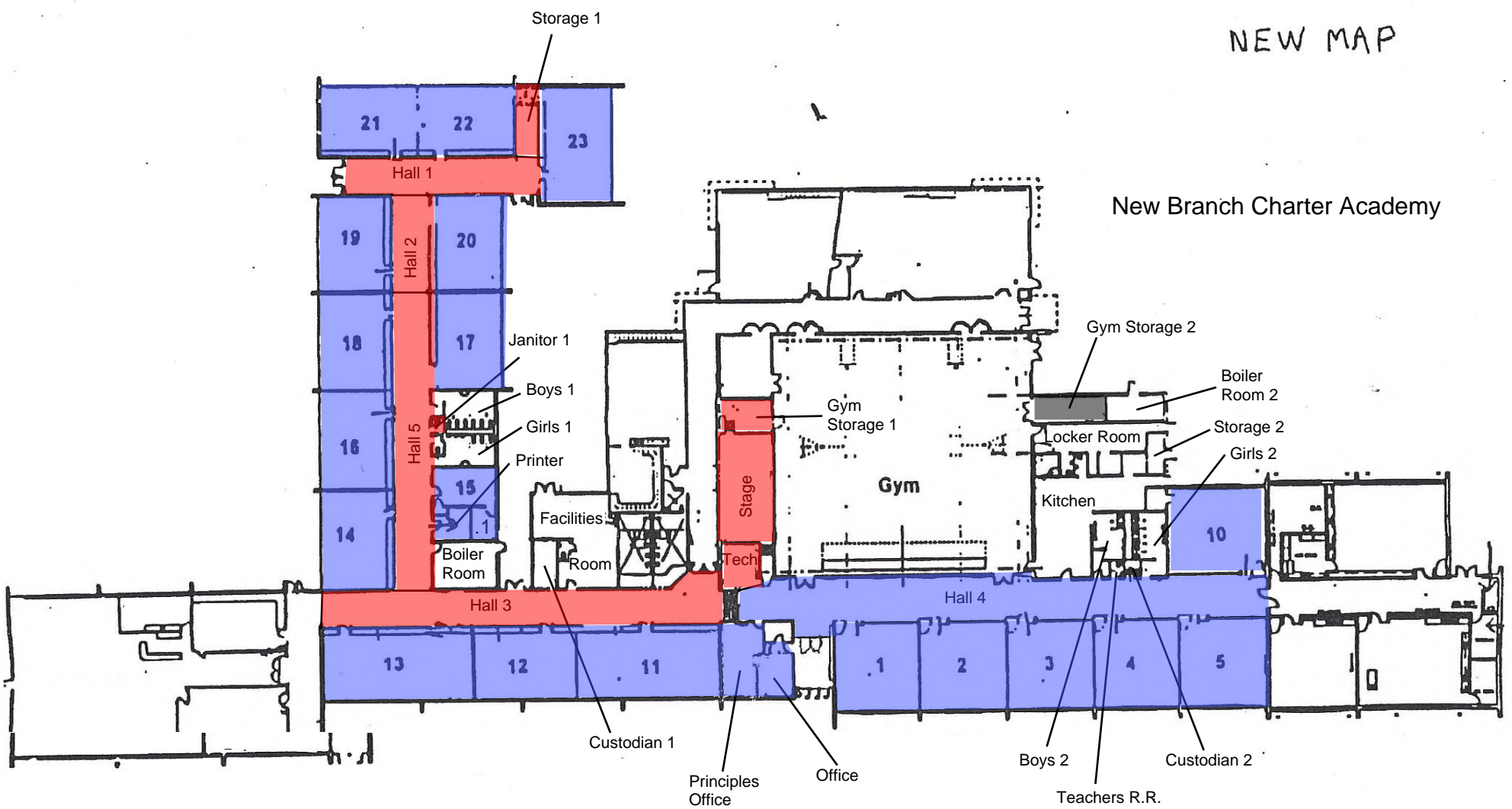

- = Assumed Asbestos Floor Covering
- = Assumed Asbestos Floor Covering Under Surface Layer
- = Previously Abated Asbestos Floor Covering