



N O R T H E R N
Analytical Services, LLC.
ENVIRONMENTAL CONSULTANTS

October 13, 2025

Project No: 250281

Mr. Kyle Root
New Branches Charter Academy
3662 Poinsettia Avenue, SE
Grand Rapids, Michigan 49508

Re: 2nd Round AHERA Periodic Surveillance Report

Dear Ms. Larkin:

The following AHERA Periodic Surveillance Report was completed for New Branches Charter Academy which is located at 3662 Poinsettia Avenue, SE, Grand Rapids, Michigan 49508. Surveillance activities were limited to the known or assumed friable asbestos containing materials identified in the most recent 3-year re-inspection report.

During this periodic surveillance, NAS found the following conditions to be true of the friable ACM materials identified in the most recent 3-year report:

- All remaining materials were found to be in good condition.

A copy of the AHERA Periodic Surveillance form (form F-4) is attached to this report.

Please do not hesitate to call if there are any questions regarding this report.

Sincerely

John J. Rehkopf
President

Northern Analytical Services, LLC.

PO Box 1604, Big Rapids, Michigan 49307 · (231) 268-0004 · Fax (866) 214-4739

Local Education Agency (LEA) Name

New Branches Charter Academy

School Building Number

1

Periodic Surveillance

1. Name of Person Performing the Surveillance:

First, M.I., Last

JaiVen Holmes-Powell

2. Date of the Surveillance:

September 17, 2025

3. Description of any Changes in the Condition of the Materials:

All remaining materials were found to be in good condition.

Northern Analytical Services

14870 225th Avenue, Big Rapids, MI 49307 - (231) 268-0004 - Fax (866) 214-4739

LEA:
Building:
Building No.:
Address:

Choice Schools Associates
New Branches Charter Academy
1
3662 Poinsettia Avenue SE
Grand Rapids, MI 49508

Response Action Report

Printed:

October 13, 2025

<i>Room Number</i>	<i>Material Number</i>	<i>Homogeneous Material Description</i>	<i>Quantity</i>	<i>Units</i>	<i>Comments</i>	<i>Response Action (AHERA Ranking)</i>
001	4	Floor Tile & Mastic -	800	Sq.Ft.	Under Carpet	Follow O&M Plan. (7)
001	8	Fire Rated Door -	0	Each	Removed	(0)
002	4	Floor Tile & Mastic -	800	Sq.Ft.	Assumed Under Vinyl Sheet Flooring	Follow O&M Plan. (7)
002	8	Fire Rated Door -	1	Each		Follow O&M Plan. (7)
003	4	Floor Tile & Mastic -	800	Sq.Ft.	Assumed Under Carpet	Follow O&M Plan. (7)
003	8	Fire Rated Door -	1	Each		Follow O&M Plan. (7)
004	4	Floor Tile & Mastic -	800	Sq.Ft.	Assumed Under Carpet	Follow O&M Plan. (7)
004	8	Fire Rated Door -	0	Each	Removed	(0)
005	4	Floor Tile & Mastic -	800	Sq.Ft.	Assumed Under Vinyl Sheet Flooring	Follow O&M Plan. (7)
005	8	Fire Rated Door -	1	Each		Follow O&M Plan. (7)
010	4	Floor Tile & Mastic -	800	Sq.Ft.	Assumed Under Carpet	Follow O&M Plan. (7)
011	4	Floor Tile & Mastic -	1100	Sq.Ft.	Assumed Under Carpet	Follow O&M Plan. (7)
011	9	Glue - Pods From Old Ceiling Tiles	1100	Sq.Ft.	Above Ceiling Tiles	Follow O&M Plan. (7)
012	4	Floor Tile & Mastic -	800	Sq.Ft.	Assumed Under Carpet	Follow O&M Plan. (7)
012	9	Glue - Pods From Old Ceiling Tiles	800	Sq.Ft.	Above Ceiling Tiles	Follow O&M Plan. (7)
013	4	Floor Tile & Mastic -	1100	Sq.Ft.	Assumed Under Carpet	Follow O&M Plan. (7)

Northern Analytical Services

14870 225th Avenue, Big Rapids, MI 49307 - (231) 268-0004 - Fax (866) 214-4739

LEA:
Building:
Building No.:
Address:

Choice Schools Associates
New Branches Charter Academy
1
3662 Poinsettia Avenue SE
Grand Rapids, MI 49508

Response Action Report

Printed:

October 13, 2025

<i>Room Number</i>	<i>Material Number</i>	<i>Homogeneous Material Description</i>	<i>Quantity</i>	<i>Units</i>	<i>Comments</i>	<i>Response Action (AHERA Ranking)</i>
013	9	Glue - Pods From Old Ceiling Tiles	1100	Sq.Ft.	Above Ceiling Tiles	Follow O&M Plan. (7)
014	4	Floor Tile & Mastic -	800	Sq.Ft.	Assumed Under Carpet	Follow O&M Plan. (7)
014	9	Glue - Pods From Old Ceiling Tiles	800	Sq.Ft.	Above Ceiling Tiles	Follow O&M Plan. (7)
015	4	Floor Tile & Mastic -	280	Sq.Ft.	Assumed Under Carpet	Follow O&M Plan. (7)
015.1	4	Floor Tile & Mastic -	80	Sq.Ft.	Assumed Under Carpet	Follow O&M Plan. (7)
016	4	Floor Tile & Mastic -	800	Sq.Ft.	Assumed Under Carpet	Follow O&M Plan. (7)
016	9	Glue - Pods From Old Ceiling Tiles	800	Sq.Ft.	Above Ceiling Tiles	Follow O&M Plan. (7)
017	4	Floor Tile & Mastic -	800	Sq.Ft.	Assumed Under Carpet	Follow O&M Plan. (7)
017	9	Glue - Pods From Old Ceiling Tiles	800	Sq.Ft.	Above Ceiling Tiles	Follow O&M Plan. (7)
018	4	Floor Tile & Mastic -	800	Sq.Ft.	Assumed Under Carpet	Follow O&M Plan. (7)
018	9	Glue - Pods From Old Ceiling Tiles	800	Sq.Ft.	Above Ceiling Tiles	Follow O&M Plan. (7)
019	4	Floor Tile & Mastic -	800	Sq.Ft.	Assumed Under Carpet	Follow O&M Plan. (7)
020	4	Floor Tile & Mastic -	800	Sq.Ft.	Assumed Under Carpet	Follow O&M Plan. (7)
020	9	Glue - Pods From Old Ceiling Tiles	800	Sq.Ft.	Above Ceiling Tiles	Follow O&M Plan. (7)
021	4	Floor Tile & Mastic -	800	Sq.Ft.	Assumed Under Carpet	Follow O&M Plan. (7)
021	9	Glue - Pods From Old Ceiling Tiles	800	Sq.Ft.	Above Ceiling Tiles	Follow O&M Plan. (7)

Northern Analytical Services

14870 225th Avenue, Big Rapids, MI 49307 - (231) 268-0004 - Fax (866) 214-4739

LEA:
Building:
Building No.:
Address:

Choice Schools Associates
New Branches Charter Academy
1
3662 Poinsettia Avenue SE
Grand Rapids, MI 49508

Response Action Report

Printed:

October 13, 2025

<i>Room Number</i>	<i>Material Number</i>	<i>Homogeneous Material Description</i>	<i>Quantity</i>	<i>Units</i>	<i>Comments</i>	<i>Response Action (AHERA Ranking)</i>
022	4	Floor Tile & Mastic -	800	Sq.Ft.	12x12in, Half Assumed Under Carpet	Follow O&M Plan. (7)
022	9	Glue - Pods From Old Ceiling Tiles	800	Sq.Ft.	Above Ceiling Tiles	Follow O&M Plan. (7)
023	4	Floor Tile & Mastic -	800	Sq.Ft.	12x12in, Half Assumed Under Carpet	Follow O&M Plan. (7)
023	9	Glue - Pods From Old Ceiling Tiles	800	Sq.Ft.	Above Ceiling Tiles	Follow O&M Plan. (7)
Boiler Room	1	Boiler Insulation - Jacket	295	Sq.Ft.		Follow O&M Plan. (7)
Boiler Room	3	Pipe Insulation-Mudded Fitting -	6	Ln.Ft.		Follow O&M Plan. (7)
Boiler Room	5	Gasket -	15	Sq.Ft.	On Boiler	Follow O&M Plan. (7)
Boiler Room	8	Fire Rated Door -	0	Each	Removed	(0)
Boiler Room 2	8	Fire Rated Door -	2	Each		Follow O&M Plan. (7)
Boys 2	3	Pipe Insulation-Mudded Fitting -	8	Ln.Ft.		Follow O&M Plan. (7)
Custodian 1	8	Fire Rated Door -	0	Each	Removed	(0)
Custodian 2	3	Pipe Insulation-Mudded Fitting -	26	Ln.Ft.		Follow O&M Plan. (7)
Custodian 2	8	Fire Rated Door -	1	Each		Follow O&M Plan. (7)
Girls 2	3	Pipe Insulation-Mudded Fitting -	4	Ln.Ft.		Follow O&M Plan. (7)
Gym Storage 1	4	Floor Tile & Mastic -	200	Sq.Ft.	9x9	Follow O&M Plan. (7)
Gym Storage 2	3	Pipe Insulation-Mudded Fitting -	0	Ln.Ft.	Abated October 2023	(0)

Northern Analytical Services

14870 225th Avenue, Big Rapids, MI 49307 - (231) 268-0004 - Fax (866) 214-4739

LEA:
Building:
Building No.:
Address:

Choice Schools Associates
New Branches Charter Academy
1
3662 Poinsettia Avenue SE
Grand Rapids, MI 49508

Response Action Report

Printed:

October 13, 2025

<i>Room Number</i>	<i>Material Number</i>	<i>Homogeneous Material Description</i>	<i>Quantity</i>	<i>Units</i>	<i>Comments</i>	<i>Response Action (AHERA Ranking)</i>
Gym Storage 2	4	Floor Tile & Mastic -	0	Sq.Ft.	Abated October 2023	(0)
Hall 1	4	Floor Tile & Mastic -	750	Sq.Ft.	12x12	Follow O&M Plan. (7)
Hall 2	4	Floor Tile & Mastic -	400	Sq.Ft.	12x12	Follow O&M Plan. (7)
Hall 3	4	Floor Tile & Mastic -	1600	Sq.Ft.	12x12	Follow O&M Plan. (7)
Hall 4	4	Floor Tile & Mastic -	1900	Sq.Ft.	9x9, Under Carpet	Follow O&M Plan. (7)
Hall 4	4	Floor Tile & Mastic -	600	Sq.Ft.	12x12, Under Carpet	Follow O&M Plan. (7)
Hall 5	4	Floor Tile & Mastic -	1100	Sq.Ft.	12x12	Follow O&M Plan. (7)
Janitor 1	4	Floor Tile & Mastic -	30	Sq.Ft.	9x9	Follow O&M Plan. (7)
Janitor 1	8	Fire Rated Door -	1	Each		Follow O&M Plan. (7)
Kitchen	3	Pipe Insulation-Mudded Fitting -	0	Ln.Ft.	Could Not Find	Follow O&M Plan. (7)
Kitchen	4	Floor Tile & Mastic -	0	Sq.Ft.	Removed	(0)
Locker Room	3	Pipe Insulation-Mudded Fitting -	20	Ln.Ft.		Follow O&M Plan. (7)
Locker Room	4	Floor Tile & Mastic -	0	Sq.Ft.	Removed	(0)
Office	4	Floor Tile & Mastic -	475	Sq.Ft.	Assumed Under Carpet	Follow O&M Plan. (7)
Principals Office	4	Floor Tile & Mastic -	350	Sq.Ft.	Assumed Under Carpet	Follow O&M Plan. (7)
Principals Office	8	Fire Rated Door -	1	Each		Follow O&M Plan. (7)

Northern Analytical Services

14870 225th Avenue, Big Rapids, MI 49307 - (231) 268-0004 - Fax (866) 214-4739

LEA:
Building:
Building No.:
Address:

Choice Schools Associates
New Branches Charter Academy
1
3662 Poinsettia Avenue SE
Grand Rapids, MI 49508

Response Action Report

Printed:

October 13, 2025

<i>Room Number</i>	<i>Material Number</i>	<i>Homogeneous Material Description</i>	<i>Quantity</i>	<i>Units</i>	<i>Comments</i>	<i>Response Action (AHERA Ranking)</i>
Printer	4	Floor Tile & Mastic -	120	Sq.Ft.	Assumed Under Carpet	Follow O&M Plan. (7)
Stage	4	Floor Tile & Mastic -	650	Sq.Ft.	12x12	Follow O&M Plan. (7)
Stage	4	Floor Tile & Mastic -	70	Sq.Ft.	9x9	Follow O&M Plan. (7)
Storage 1	4	Floor Tile & Mastic -	130	Sq.Ft.	9x9	Follow O&M Plan. (7)
Storage 1	8	Fire Rated Door -	2	Each		Follow O&M Plan. (7)
Storage 2	3	Pipe Insulation-Mudded Fitting -	10	Ln.Ft.		Follow O&M Plan. (7)
Storage 2	3	Pipe Insulation-Mudded Fitting -	1	Ln.Ft.	Roof Drain	Follow O&M Plan. (7)
Storage 2	8	Fire Rated Door -	1	Each		Follow O&M Plan. (7)
Teachers R.R.	4	Floor Tile & Mastic -	0	Sq.Ft.	Removed	()
Tech	4	Floor Tile & Mastic -	110	Sq.Ft.	9x9	Follow O&M Plan. (7)
Tunnel	2	Pipe Insulation - Wrap	110	Ln.Ft.		Follow O&M Plan. (7)
Tunnel	3	Pipe Insulation-Mudded Fitting -	217	Ln.Ft.		Follow O&M Plan. (7)

NEW MAP

New Branch Charter Academy

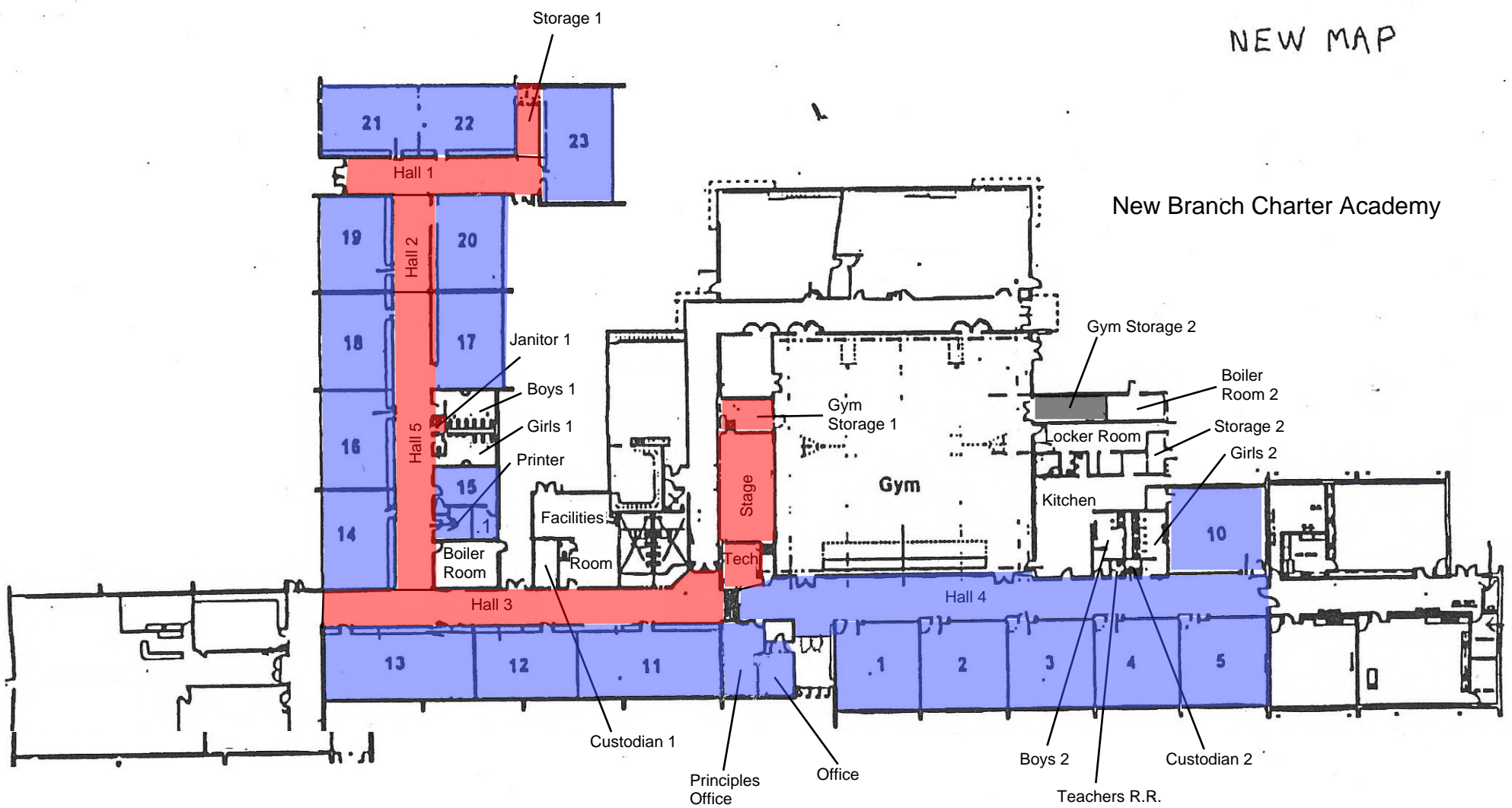

- = Assumed Asbestos Floor Covering
- = Assumed Asbestos Floor Covering Under Surface Layer
- = Previously Abated Asbestos Floor Covering